

WHEEL, STEERING SPORT WHEELS CJ-5,6,7,8, SCRAMBLER

Figure 19-200

81J19 200

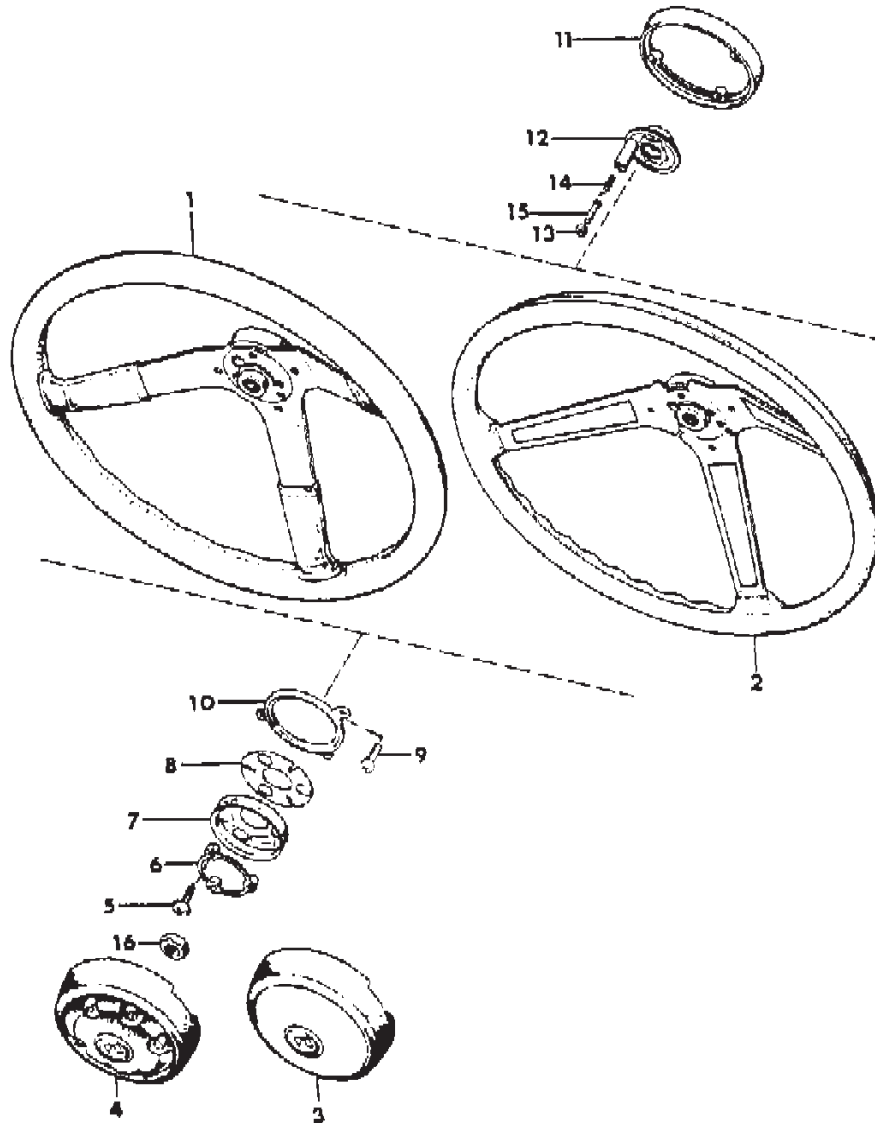

ITEM	PART NUMBER	QTY	BODY	MODEL	DESCRIPTION
1	WHEEL, Steering, Leather Wrap				
	J813 3026	1			1981-86: Black
	J813 3249	1			1981: Blue
	J813 3814	1			1982-83: Blue
	8351 0066	1			1984-85: Dark Almond
	J813 3246	1			1981-83: Medium Brown
	J813 3247	1			1981-85: Nutmeg
	8351 0067	1			1985: Garnet
	8351 0068	1			1985: Honey
	8350 2195	1			1986: Honey
2	WHEEL, Steering, Soft Feel				
	J813 3016	1			1981-86: Black
	J813 3017	1			1981: Blue
	J813 3813	1			1982-83: Blue
	8351 0063	1			1984-85: Dark Almond
	J813 3020	1			1981-83: Medium Brown
	J813 3019	1			1981-85: Nutmeg
	8351 0065	1			1985: Honey
	8350 2199	1			1986: Honey
	3	BUTTON, Steering Wheel			
J536 2573		1			1981-86: Black
J536 2574		1			1981: Blue
J536 3677		1			1982-83: Blue
J536 4993		1			1984-85: Dark Almond
J536 2576		1			1981-83: Medium Brown
J536 2575		1			1981-85: Nutmeg
J536 5129		1			1985: Garnet
J536 5126		1			1985: Honey
5200 1629		1			1986: Honey
4	BUTTON, Steering Wheel				
	J536 2582	1			1981-86: Black
	J536 2583	1			1981: Blue
	J536 3644	1			1982-83: Blue
	J536 4992	1			1984-85: Dark Almond
	J536 2585	1			1981-83: Medium Brown
	J536 2584	1			1981-85: Nutmeg
J536 5127	1			1985: Honey	
5	J400 4167	3			SCREW
6	J318 6964	1			BUSHING

MODEL CODES

16=Cherokee 2 Dr.(1981-83)	78=Cherokee 4WD-4 Dr.(1984-86)	64=Comanche 2WD-6 Ft. Box(1986)	25=J-10 Truck 7 Ft. Box(1981-84)
17=Cherokee 2 Dr.(1981-83)	85=CJ-5 (1981-83)	66=Comanche 2WD-7 Ft. Box(1986)	26=J10 Truck 8 Ft. Box(1981-86)
73=Cherokee 2WD-2 Dr.(1984-86)	86=CJ-6(1981)	63=Comanche 4WD-6 Ft. Box(1986)	27=J-20 Truck 8 Ft. Box(1981-86)
74=Cherokee 2WD-4 Dr.(1984-86)	87=CJ-7(1981-86)	65=Comanche 4WD-7 Ft. Box(1986)	15=Wagoneer 4 Dr.(1981-83)
18=Cherokee 4 Dr.(1981-83)	88=CJ-8, Scrambler(1981-86)	15=Grand Wagoneer 4 Dr.(1984-86)	75=Wagoneer 4WD-4 Dr.(1984-86)
77=Cherokee 4WD-2 Dr.(1984-86)			

BODY

CJ=CJ-5, CJ-6, CJ-7, CJ-8, Scrambler(1981-86)  
MJ=Comanche Pickup(1986)

STYLES

SJ=Wagoneer(1981-83), Grand Wagoneer(1984-86),  
Cherokee(1981-83), J-10, J-20(1981-86)  
XJ=Wagoneer(1984-86), Cherokee(1984-86)

AR = Use as Required - = Non Illustrated Part P.A.R. = Paint as Required